

Aluminium profiles AL-1 & AL-1i



The AL-1 and AL-1i are a discreet profiles with a shallow depth, making ideal for use in installations where the profile is not visible, but light output is. This profiles are ideal for use with lower wattage LED strips.

Surface mounted



Inset



Dimensions

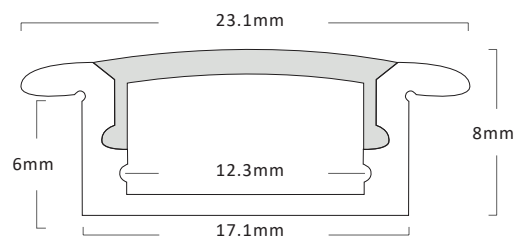
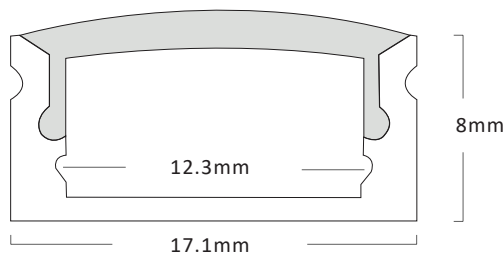

Note

For compatibility of LED strip with aluminium profile, please refer to the compatibility chart in our catalogue or on our website:

www.teucerled.co.uk/compatibilitychart



Technical specification

Surface mounted	AL-1/1M	AL-1/2M
Inset	AL-1i/1M	AL-1i/2M
Length	1m	2m
Construction	anodised aluminium 6063	
IP rating	IP20	

Compatible diffusers

Code	Length	Finish	Construction
DIF-C/1M	1m	clear	polycarbonate
DF-F/1M	1m	frosted	polycarbonate
DIF-O/1M	1m	opal	polycarbonate
DIF-C/2M	2m	clear	polycarbonate
DIF-F/2M	2m	frosted	polycarbonate
DIF-O/2M	2m	opal	polycarbonate

Accessories

Code	Profile	Item
AL-1/CLIP	Surface mounted	Two mounting clips, 1 pc end cap with hole & 1 pc end cap without hole
AL-1i/ENDCAPS	Inset	1 pc end cap with hole & 1 pc end cap without hole

Note

For compatibility of LED strip with aluminium profile, please refer to the compatibility chart in our catalogue or on our website:

www.teucerled.co.uk/compatibilitychart

Teucer (UK) Ltd
Head office

Bedford House, Fulham Green
69-79 Fulham High Street
London, SW6 3JW, UK
Tel: +44 (0)20 7350 4429
Fax: +44(0)20 7228 4647
www.teucerled.co.uk
sales@teucer.eu

