

LR-6TW and LRR-WTC

6 zone RF & WIFI controller and receiver for tunable white LED strip

Product Description

Teucer's tunable white controller enables control of up to 6 zones, as well as dimming and scene saving options. Tunable white control enables users to change LED strip colour temperature from warm white to daylight (i.e. 2700k-6000K). This product can be used in conjunction with the LR-WTC receiver, LR-WIFI trans and the Easy lighting app therefore allowing any Android or Apple smartphone/tablet to simultaneous control the lighting wirelessly whilst maintaining synchronous operations.

Features

- Adjust colour temperatures and brightness
- Smartphone / tablet compatible via Easy Lighting app
- Wireless RF range of 8-15 meters (depending on signal obstacles within the installation area)
- Control up to 6 zones independently or simultaneously
- 5%-100% smooth dimming
- Save up to 6 scenes per zone

Technical Specification

| Controller | |
|---------------------|---------------------|
| Order Code | LR-6TW |
| Type | RF remote |
| Input Voltage | 3.6VDC |
| Operation Frequency | 868/915/434 MHz |
| Dimension | 47x140x16mm (WxLxH) |
| Power | 3 x AAA Batteries |

| Receiver | |
|---------------|---------------------|
| Order Code | LRR-WTC |
| Type | RF receiver |
| Input Voltage | 12-36VDC |
| Current | 4X5A |
| Output | 4X(60-180)W |
| Note | Constant voltage |
| Dimension | 46x178x22mm (WxLxH) |



Recommendation

RF technology allows for greater flexibility when it comes to controlling simple or complex lighting installations without the need of additional cabling.

There are some limitations where installations have the receivers enclosed in electrical boxes or hidden away in a ceiling, reducing the RF signal strength and therefore the communication range.

In order to overcome these RF Signal restrictions we suggest the following when synchronising our RF controllers and receivers:

- Keep the distance within 10 meters from the controller to the receiver
- When expanding your lighting, always try and use a signal repeater (PR-RGB), where possible.
- If your installation requires several RF receivers, ensure the "master" receiver is positioned in the middle.

CONTROLLER AND RECEIVER

LR-6TW and LRR-WTC

6 zone RF & WIFI controller and receiver for tunable white LED strip

Controller layout

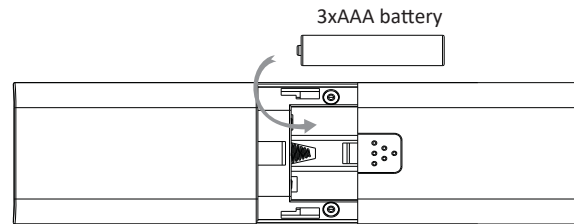
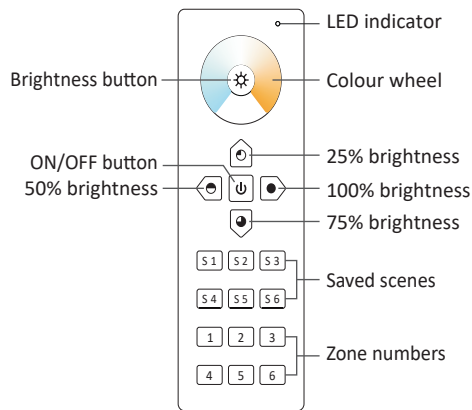

Receiver wiring diagram

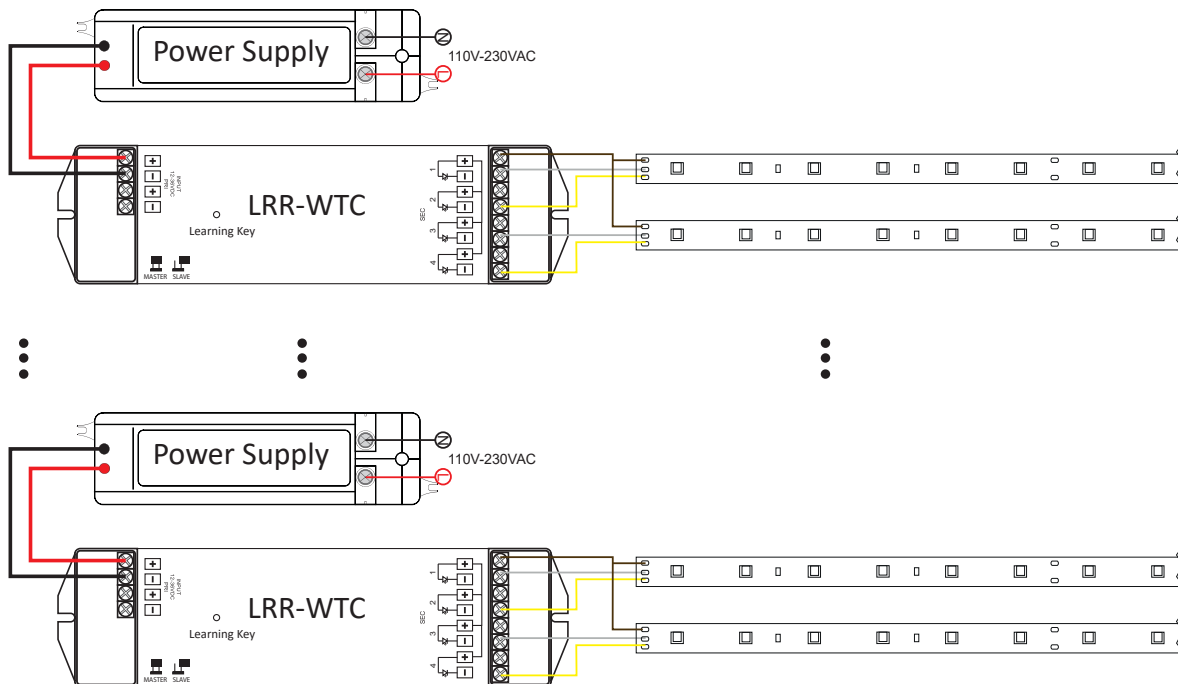

When wiring the receivers, it is important to make sure the total wattage of the LED strips does not exceed the maximum rated wattage per channel of the receiver. Each channel is rated at 5A, so the maximum wattage per channel is $24 \times 5A = 120W$. The power supply has to match the rated voltage and be superior to the total LED strip wattage by a recommended 10%.

CONTROLLER AND RECEIVER

LR-6TW and LRR-WTC

6 zone RF & WIFI controller and receiver for tunable white LED strip

Synchronising the controller to receiver

1) Turn the controller ON. Red LED indicator will be light up.

2) Set the receiver LRR-WTC as a MASTER OR SLAVE.

Allocating the receiver as a master or slave is important to ensure your LED strip and receiver are fully synchronised. There can be only 1 master receiver per zone.

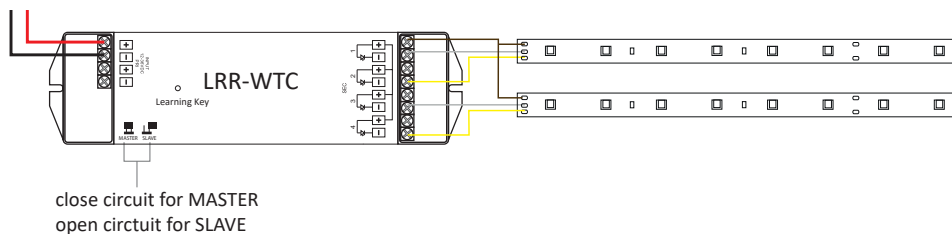

3) Ensure the receiver has power. Press the learning key on the receiver.

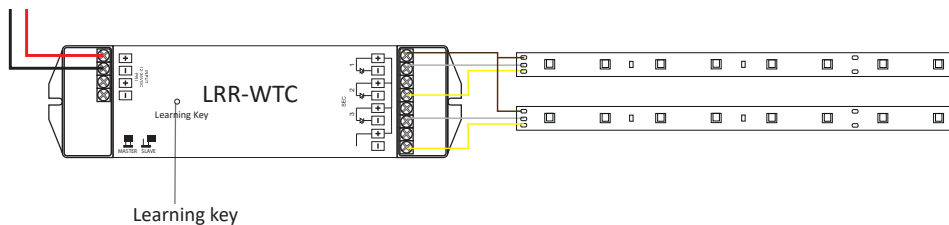

4) Ensure the controller is active (red light indicator ON) and press the zone you which to allocate to the receiver, than touch the colour wheel. The LED strips will blink to confirm synchronisation has been successful.

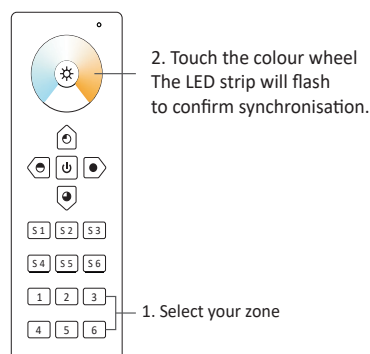

5) Just repeat the learning process to synchronise several receivers to the same controller.

6) To clear the receiver from a selected zone, simply press and hold the learning key for 5 or more seconds. The receiver will be reset to the default factory settings.

CONTROLLER AND RECEIVER



Brighter for longer

LR-6TW and LRR-WTC

6 zone RF & WIFI controller and receiver for tunable white LED strip

Controlling your LED strip

With LR-6TW one can adjust the brightness and colour temperature of the tunable white LED strip.

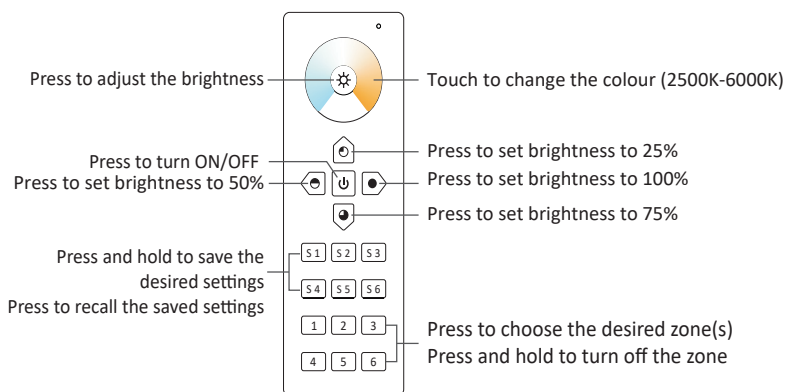

- Choose the zone(s) you wish to control. Select as many zones as you wish.
- Touch the colour wheel to adjust the colour from 2500K-6000K.
- Adjust the brightness by choosing one out of four already set brightness levels (25%, 50%, 75% or 100%) or set it yourself by pressing the brightness button.

- To save a specific colour and brightness that is displayed, choose the zone that is displaying the desired colour then press and hold S1, S2, S3, S4, S5 or S6. The LED strip will flash to confirm that the setting has been successfully saved.
- To recall a saved setting, select your zone and press S1, S2, S3, S4, S5 or S6 .
- There is a maximum of 6 preferred scene settings per zone.
- To save over an existing setting, just follow the same procedure.

Safety

- Products must be installed and serviced by qualified electrician.
- Please ensure the receiver is mounted in a water proof enclosure if installed in an outdoor environment, avoiding metallic enclosures.
- Always ensure products are mounted in areas with adequate ventilation to avoid overheating.
- Please ensure outputs of any power suppliers used in conjunction with this product comply with its working voltage.
- Never install product whilst connected to power and double check connections before switching on to avoid short circuits.

Warranty

Should this product fail during the 3 year warranty period it will be replaced free of charge, subject to the correct installation of the original product in accordance with applicable and appropriate electrical codes and instructions provided by Teucer, as well as subsequent return of the faulty unit. Teucer does not accept responsibility for any installation costs associated with the replacement of this product and Teucer reserves the right to alter specifications without prior notice. Teucer can offer 5 year warranty upon request. For further information, please see our Terms and Conditions. www.teucerled.co.uk/terms-and-conditions/

Teucer (UK) Ltd
Head office

Bedford House, Fulham Green, Fulham High Street,
London, SW6 3JW, UK
Tel: +44 (0)20 7350 4429
Fax: +44(0)20 7228 4647
www.teucerled.co.uk
sales@teucer.eu

Logistics Centre

Trident Court,
1 Oakcroft Road,
Chessington,
Surrey, KT9 1BD, London, UK
Tel: +44(0)20 7350 4429, extension: 401
warehouse@teucer.eu

